

Model 1011-1511 Thermostatic Control Valve Specifications - Metric

Valves		PRINCIPAL DIMENSIONS - mm		Weight - kg	
MODEL NUMBER	CONNECTION SIZE	A	B (SQUARE)	A	B
*1011	1/2 NPT	152.4	96.5	3.8	4.6
*1111	3/4 NPT				
*1211	1/2 NPT				
*1411	1 1/4 NPT				
*1511	1 1/2 NPT			3.8	4.6
*1011A	1/2 BSPP				
*1111A	3/4 BSPP				
*1211A	1/2 BSPP				
*1411A	1 1/4 BSPP				
*1511A	1 1/2 BSPP			3.8	4.6
*1011B	1/2 BSPT				
*1111B	3/4 BSPT				
*1211B	1/2 BSPT				
*1411B	1 1/4 BSPT				
*1511B	1 1/2 BSPT			3.6	4.4
*1011J8	3/4-16 UNF				
*1011J12	1 1/16-12 UNF				
*1011J14	1 3/16-12 UNF				
*1011J16	1 5/16-12 UNF				
*1011J20	1 5/8-12 UNF				
*1011J24	1 7/8-12 UNF				
*1011JU33	M33 X 2				
*1011JU42	M42 X 2				
*1011JU48	M48 X 2				

REPLACE * WITH BODY MATERIAL: A= CAST IRON, B= BRONZE (WEIGHTS ARE APPROXIMATE)

Pressure Ratings	
MATERIAL	bar
A	10.3
B	12.4

Standard Service Kits	
MODEL	SEAL MATERIAL
1500-XXX	Buna-N
1500V-XXX	Viton
1500E-XXX	Neoprene

REPLACE XXX WITH
SET-POINT TEMPERATURE °F
(One thermostat per valve)

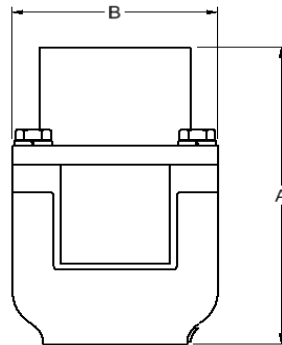

Application Schematic

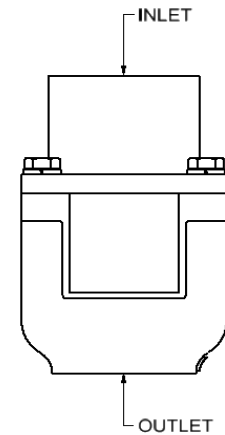

Consult FPE representative for further information

www.FPEvalves.com

EUROPE, MIDDLE EAST,
AFRICA, ASIA + PACIFIC
+44 1733 206 678
emeaap@FPEvalves.com

AMERICAS
+1 262 548 6220
americas@FPEvalves.com

CHINA
+86 0519 8158 0102
china@FPEvalves.com

Copyright 2017 FPE.