

# Model 0750 Thermostatic Valve Specifications - Standard

3-Way Valves		PRINCIPAL DIMENSIONS UNITS - in					Weight - lb	
MODEL NUMBER	CONNECTION SIZE	A	B	C	D	E	AL	B
*0752	1/2 NPT	4.6	3.3	2.3	1.8	2.1	1.4	3.6
*0752B	1/2 BSPT							
*0750	3/4 NPT							
*0750B	3/4 BSPT							
*0752A	1/2 BSPP	5.0	4.0	2.7	2.1		1.5	4.0
*0750A	3/4 BSPP							
*0750J8	SAE-8							
*0750J12	SAE-12							
*0750J16	SAE-16							

2-Way Valves		PRINCIPAL DIMENSIONS UNITS - in					Weight - lb	
MODEL NUMBER	CONNECTION SIZE	A	B	C	D	E	AL	B
*0752JW	1/2 NPT	5.1	3.3	2.9	2.3	2.1	1.6	3.7
*0752JWB	1/2 BSPT							
*0750JW	3/4 NPT							
*0750JWB	3/4 BSPT							
*0752JWA	1/2 BSPP	5.1	4.0	3.0	2.3		1.6	4.0
*0750JWA	3/4 BSPP							
*0750JWJ8	SAE-8							
*0750JWJ12	SAE-12							
*0750JWJ16	SAE-16							

REPLACE \* WITH BODY MATERIAL: AL= ALUMINUM, B= BRONZE (WEIGHTS ARE APPROXIMATE)

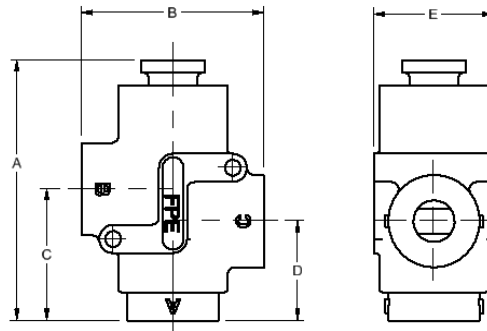

AL0750 SHOWN AS EXAMPLE

## Application Schematics

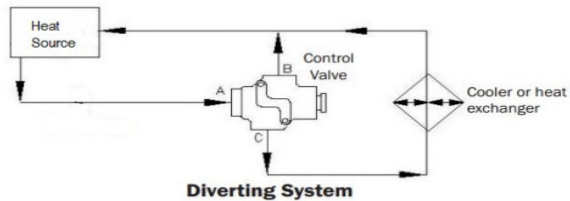
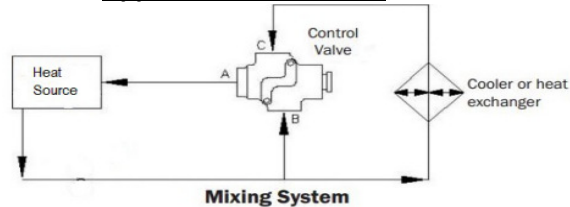

Pressure Ratings	
MATERIAL	PSI
AL	350
B	350

Standard Service Kits	
MODEL	SEAL MATERIAL
0700-XXX	Buna-N
0700V-XXX	Viton
0700E-XXX	Neoprene

REPLACE XXX WITH  
SET-POINT TEMPERATURE °F  
(One thermostat per valve)

Consult FPE representative for further information

[www.FPEvalves.com](http://www.FPEvalves.com)

EUROPE, MIDDLE EAST,  
AFRICA, ASIA + PACIFIC  
+44 1733 206 678  
[emeaap@FPEvalves.com](mailto:emeaap@FPEvalves.com)

AMERICAS  
+1 262 548 6220  
[americas@FPEvalves.com](mailto:americas@FPEvalves.com)

CHINA  
+86 0519 8158 0102  
[china@FPEvalves.com](mailto:china@FPEvalves.com)

Copyright 2017 FPE.